



Test Equipment Signal Connectors

Product description

Quick release standard-density signal test connector (2,54 mm x 2,54 mm pitch)

Features

- Drop-in replacement for standard ZIF connectors
- 1/2 Turn quick mating device
- Self cleaning, high reliability contacts
- Rugged design

Advantages

High reliability alternative to ZIF connectors

Markets

Aerospace testing, medical equipment, industrial test/burn-in applications

Technical Characteristics

Contact Number	60, 96 & 156 ways
Contact Diameter	0,60 mm
Current Rating	4 A
Contact Resistance	7 Milli-Ohm (max)
Contact mating force	0,28 N (average)
Contact Life Cycle	> 10,000
Breakdown Voltage Between Contacts	1920 V AC (min) [sea level]
Dielectric Withstanding Voltage	1400 V AC (min) [sea level]
Temperature Rating	-55 to +125 Degree C
Insulation Resistance	5 Giga-Ohm @ 500 V DC (min)
Insulator Material	PPS
Contact - Material - Plating (Mating surfaces)	Copper alloy 1,27 micro-metres Gold Plate (min)
Guide Hardware - Material - Plating	Stainless steel BS 303 Passivated
Plating Reference	N/A

Ordering Information

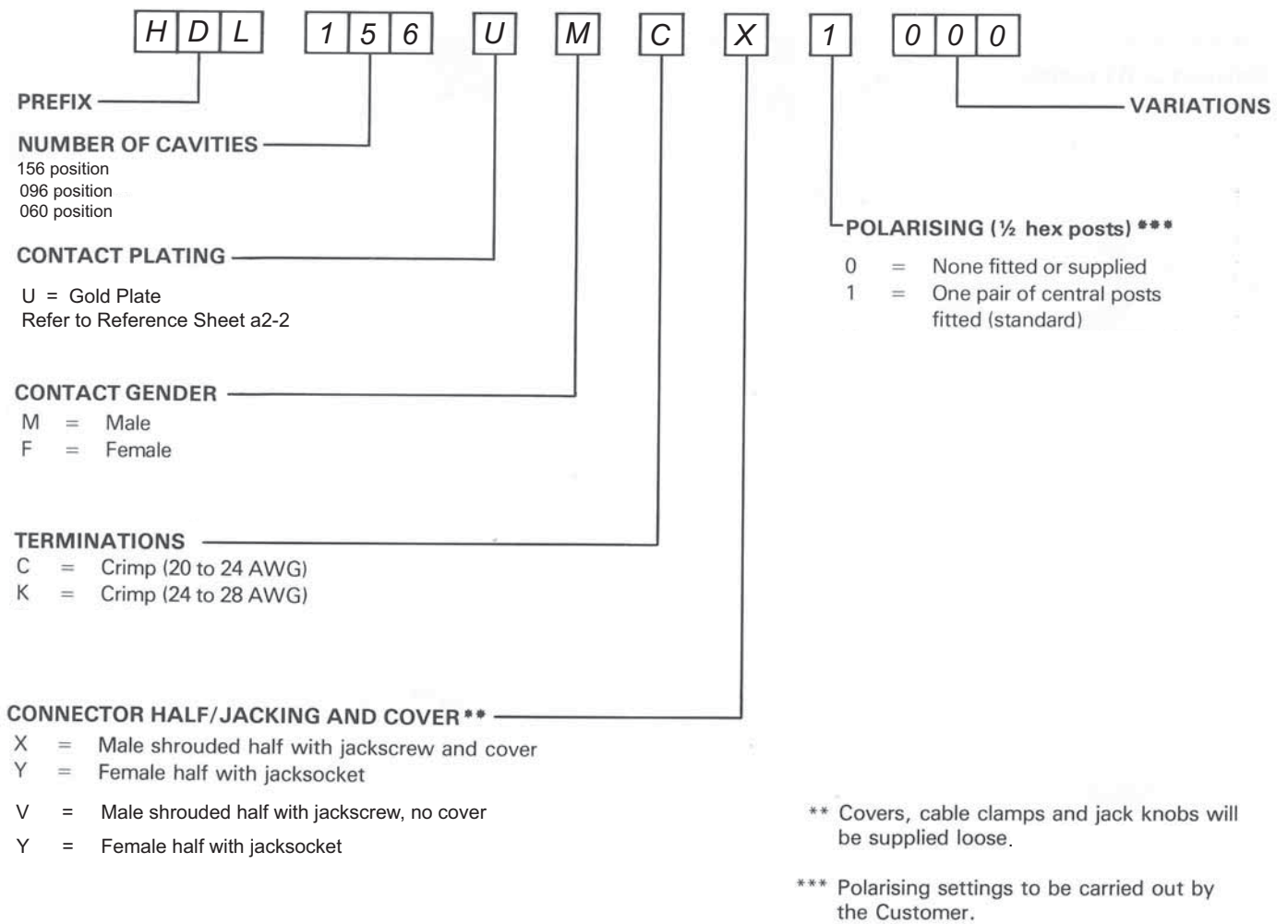

HDL 156 contacts

MALE CONNECTOR

(Shows with cover fitted)

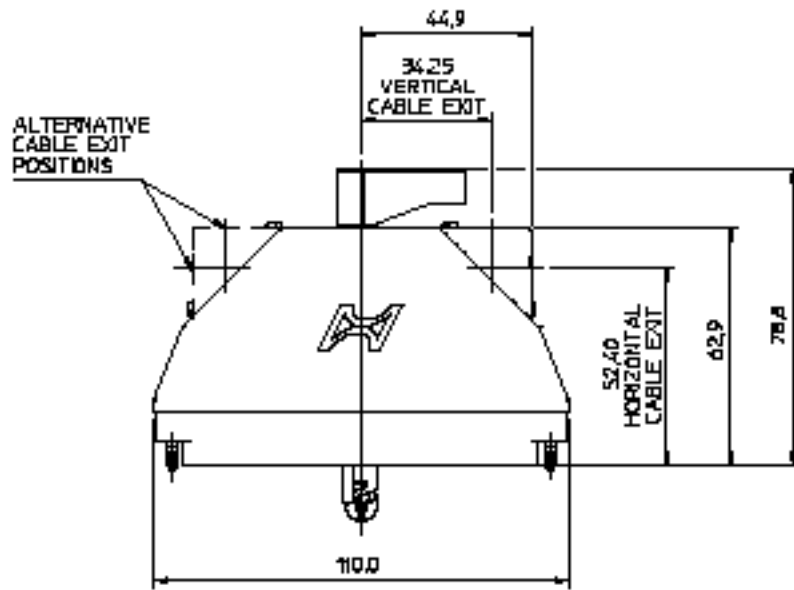

MALE CONNECTOR

(MATING FACE)

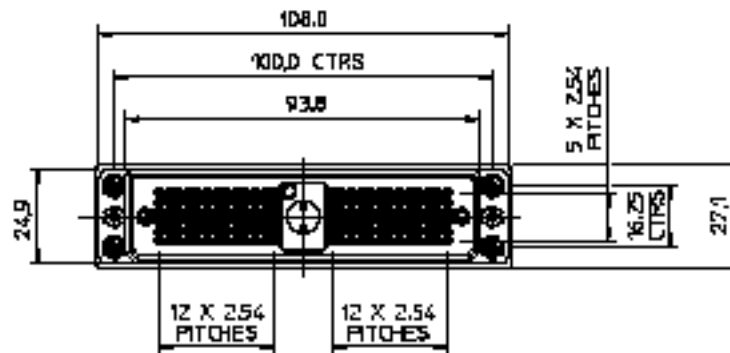

FEMALE CONNECTOR



FEMALE CONNECTOR

(MATING FACE)

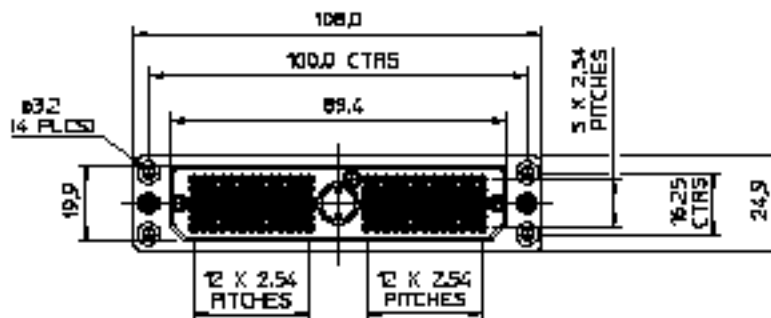

PANEL CUT OUT

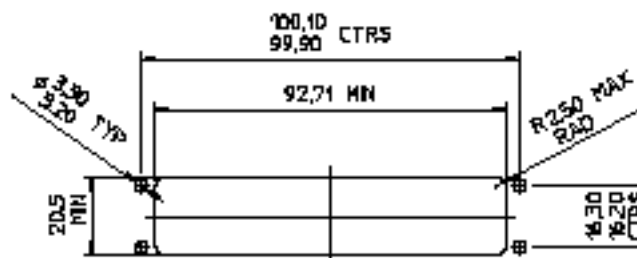

Dimensions are in mm

HDL 096 contacts

MALE CONNECTOR
(Shown with cover fitted)

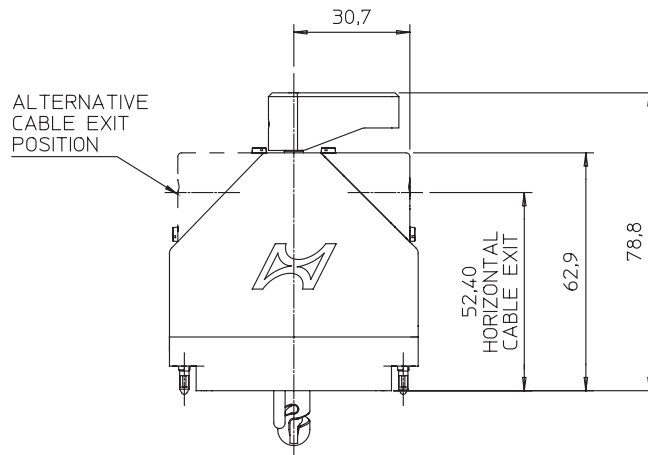

MALE CONNECTOR
(MATING FACE)

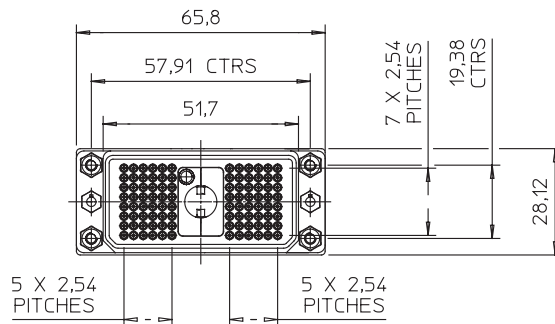

FEMALE CONNECTOR

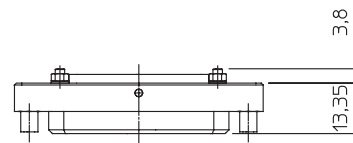

FEMALE CONNECTOR
(MATING FACE)

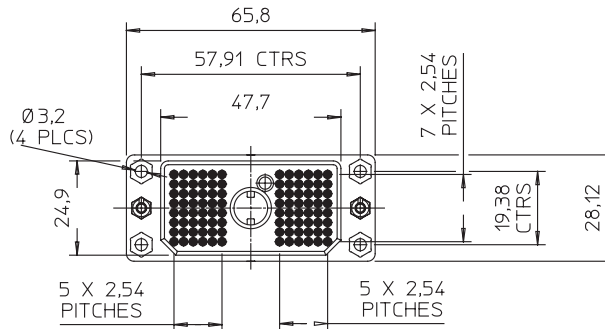

PANEL CUT OUT

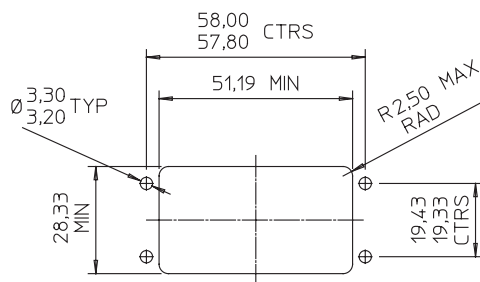

HDL 060 contacts

MALE CONNECTOR
(Shows with core fitted)

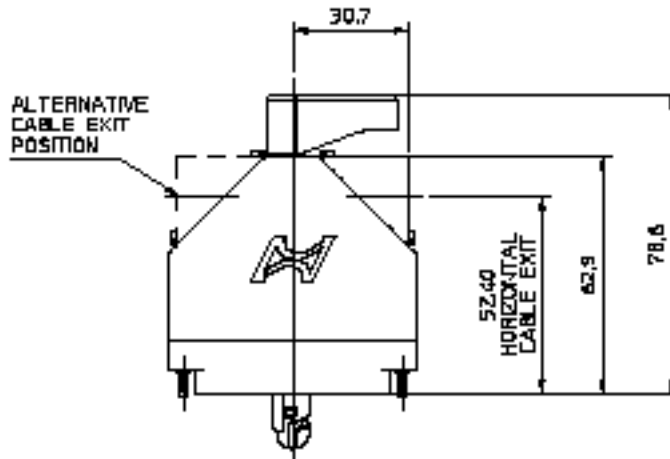

MALE CONNECTOR
(MATING FACE)

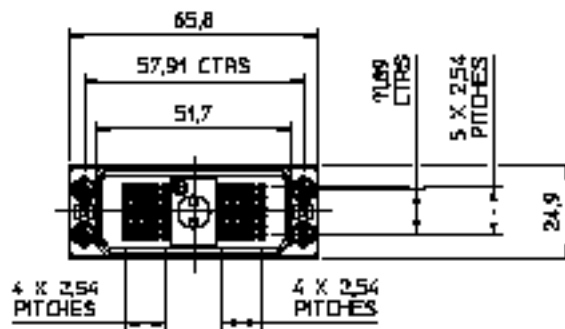

FEMALE CONNECTOR



FEMALE CONNECTOR
(MATING FACE)

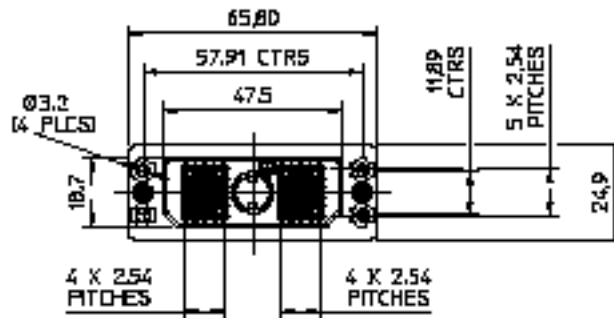

PANEL CUT OUT

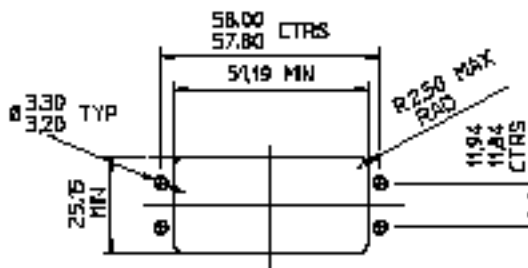

Crimping Information

AWG	Number and nominal diameter of wires	Crimp tool selector setting position
20	19/0.20mm	6
22	19/0.15mm	5
24	7/0.20mm	4
26	7/0.15mm	3
28	7/0.125mm	2

Tools

Contact extraction tool	: HPD 286
Spare tips for above	: HPD 280
Contact insertion tool	: Use non-ferrous long pointed tweezers
Crimp tool positioner	: HPD 309A
Crimp tool	: MIL-C-22520/2-01