

L-Series



300 AMP HIGH POWER MODULES L-SERIES MODULAR CONNECTORS

300 amp High Power modules provide robustness, vibration resistance and easy handling

Hypertac has launched a new generation of high power modules which meet the technical requirements of on board supply systems for railways and avionics, electrical power and auxiliary power supplies as well as test and measurement power-supply units. The new high power modules are a supplement to the existing modules of the Hypertac L-Series. The modules are designed for a nominal current up to 300 amp and can be used for building up either a onepole or a multi-pole high power connector. They can be combined within one connector with other signal, power and coax modules of the L-Series. As these connectors are fitted in a modular way, the combination itself can be determined by the customer.

Cables are fixed by crimp termination and connected via a cable lug. This permits usage of stranded fine and superfine copper wires by using standard crimping tools. Contacts can be inserted and extracted quite simply without any special tooling into the insulator – an additional customer advantage.

The main technical benefits of the 300 amp modules are:

- Contact diameter: 9 mm with screwed connection M 8x1 for cable lug
- Recommended cable cross section: 120 mm² (AWG 5/0)
- Nominal current: 300 amp @ 20 °C
- Contact resistance: <1 mΩ

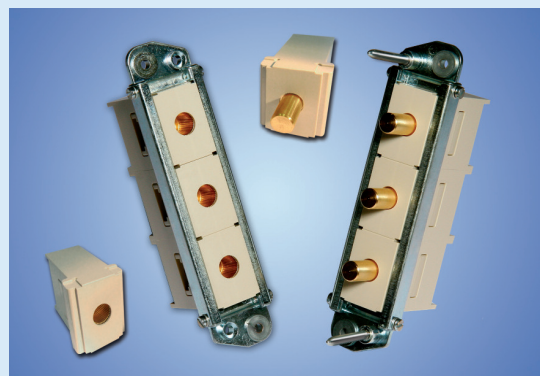

The Hypertac Hyperboloid Contact technology offers resistance to vibration under extremely rough conditions. The spring wires within the socket are set at an angle to the centre line and are deflected when the mating pin contact enters. Each spring wire is deflected within its elastic limit and makes a line contact with the pin. A smooth wiping action reduces wear of the plating surfaces of the pin and socket wires. This construction allows a very tight control of the spring forces and hence the insertion and withdrawal forces.

Technical Characteristics Single Module

Electrical		Mechanical	
Contacts with screwed connection M 8x1 for cable lug	ø 9 mm	Contact insertion & separation force	1,5 N - 2 N
Nominal current	300 amp @ 20 °C	Mating cycles	≥500
Nominal Voltage	600 V	Contact retention force	1000 N
Contact resistance	<1 mΩ	Operating temperature	-40 °C to 125 °C
Environmental			
Overvoltage category	II	Contamination level	2
Installation altitude	2000 m		

Recommended cable cross section: 120 mm² (AWG 5/0), fine and superfine copper wires

Ordering Information

Description	Part number
Module 1pole pin	060.001037.2000
Module 1pole socket	060.001036.2000
Crimp lug 120 mm ²	723.006.1000

Drawings and Dimensions

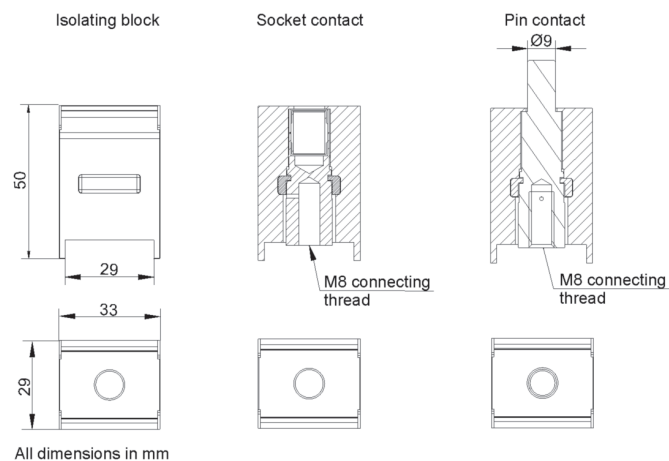

The modules are designed for installation in L-Series frame typ "H" using long guiding pins

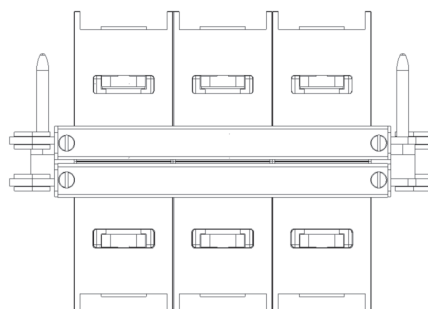

This drawing shows an installation example.
In an arrangement of multiple high power modules electrical data can differ from the single module.

More information on our website www.hypertac.com